

DECK LAYOUTS

Odyssey III is licensed by the United States Coast Guard to carry 670 passengers and crew.

At times when wind and tide conditions prevent navigation to the Kennedy Center and Georgetown, an alternate route south on the Potomac and past historic Old Town Alexandria will be taken.

SAN MATEO ROOM

Maximum Capacity: 200 Reception Style
180 Seated
Passenger Dining Area: 3100 Sq. Ft.
Bar: Full service
Dance Floor Area: 13' x 20'



MARIN ROOM

Maximum Capacity: 200 Reception Style
150 Seated
Passenger Dining Area: 3050 Sq. Ft.
Bar: Full service
Dance Floor Area: 16' x 22'



CARNEROS ROOM

Maximum Capacity: 100 Reception Style
80 Seated
Passenger Dining Area: 1275 Sq. Ft.
Bar: Waitstaff service
This area can be divided in half to accommodate two private parties of 40 passengers.

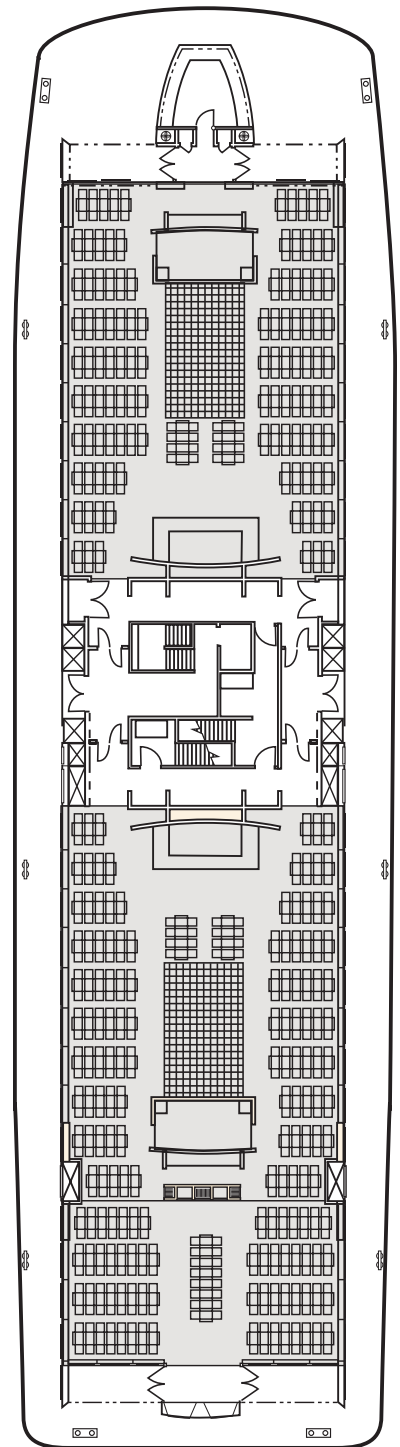

www.EntertainmentCruises.com | 202/488.6010

ODYSSEY